

AERODROME
CHART - ICAO

36°42'59"N
127°29'57"E

ELEV 192 ft

TWR 118.7 126.2
GND 121.875

CHEONGJU / Cheongju INTL

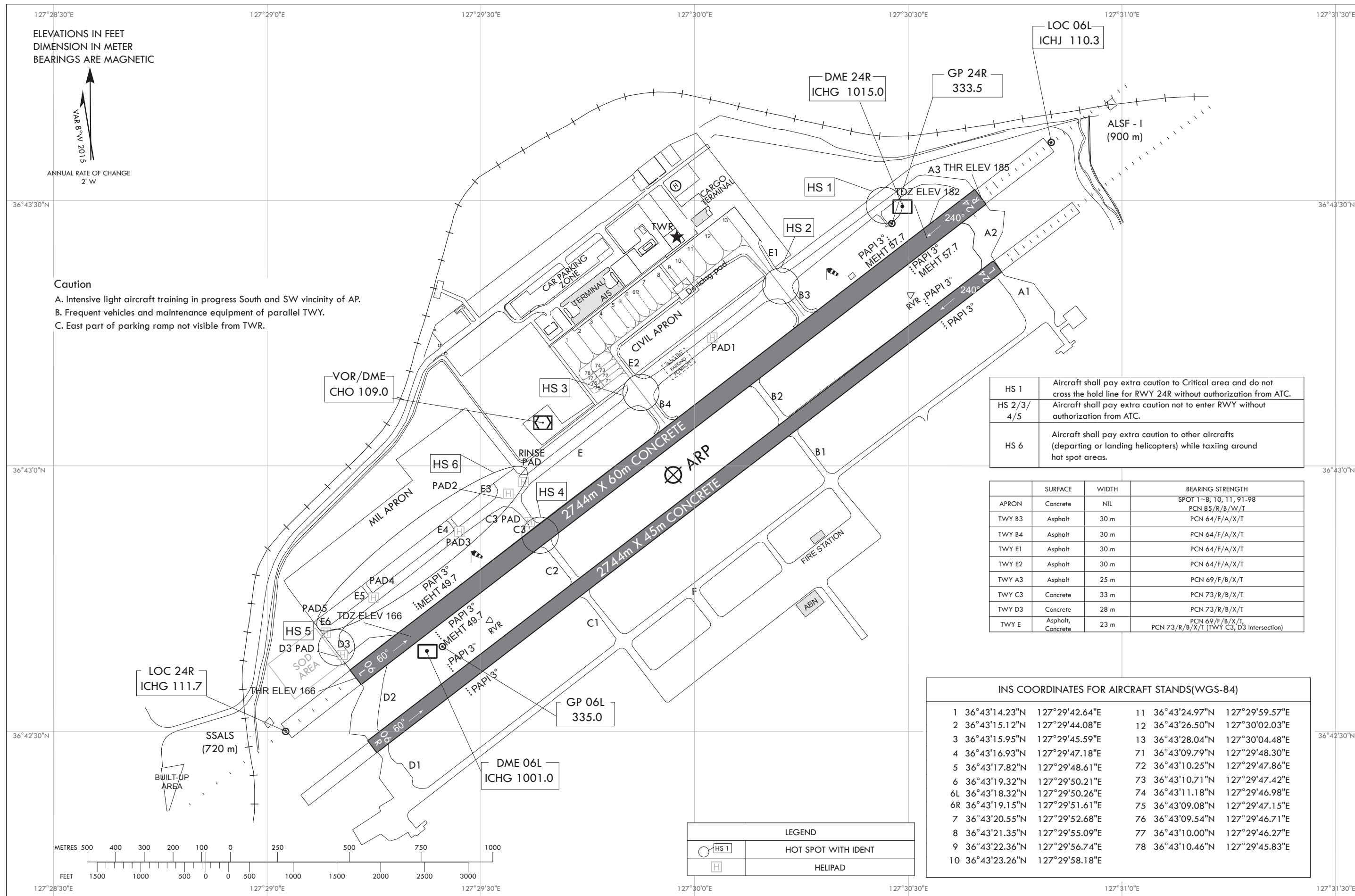

HS 1	Aircraft shall pay extra caution to Critical area and do not cross the hold line for RWY 24R without authorization from ATC.
HS 2/3/4/5	Aircraft shall pay extra caution not to enter RWY without authorization from ATC.
HS 6	Aircraft shall pay extra caution to other aircrafts (departing or landing helicopters) while taxiing around hot spot areas.

	SURFACE	WIDTH	BEARING STRENGTH
APRON	Concrete	NIL	SPOT 1-8, 10, 11, 91-98 PCN 85/R/B/W/T
TWY B3	Asphalt	30 m	PCN 64/F/A/X/T
TWY B4	Asphalt	30 m	PCN 64/F/A/X/T
TWY E1	Asphalt	30 m	PCN 64/F/A/X/T
TWY E2	Asphalt	30 m	PCN 64/F/A/X/T
TWY A3	Asphalt	25 m	PCN 69/F/B/X/T
TWY C3	Concrete	33 m	PCN 73/R/B/X/T
TWY D3	Concrete	28 m	PCN 73/R/B/X/T
TWY E	Asphalt, Concrete	23 m	PCN 69/F/B/X/T, PCN 73/R/B/X/T (TWY C3, D3 Intersection)

INS COORDINATES FOR AIRCRAFT STANDS(WGS-84)			
1	36°43'14.23"N	127°29'42.64"E	11 36°43'24.97"N 127°29'59.57"E
2	36°43'15.12"N	127°29'44.08"E	12 36°43'26.50"N 127°30'02.03"E
3	36°43'15.95"N	127°29'45.59"E	13 36°43'28.04"N 127°30'04.48"E
4	36°43'16.93"N	127°29'47.18"E	71 36°43'09.79"N 127°29'48.30"E
5	36°43'17.82"N	127°29'48.61"E	72 36°43'10.25"N 127°29'47.86"E
6	36°43'19.32"N	127°29'50.21"E	73 36°43'10.71"N 127°29'47.42"E
6L	36°43'18.32"N	127°29'50.26"E	74 36°43'11.18"N 127°29'46.98"E
6R	36°43'19.15"N	127°29'51.61"E	75 36°43'09.08"N 127°29'47.15"E
7	36°43'20.55"N	127°29'52.68"E	76 36°43'09.54"N 127°29'46.71"E
8	36°43'21.35"N	127°29'55.09"E	77 36°43'10.00"N 127°29'46.27"E
9	36°43'22.36"N	127°29'56.74"E	78 36°43'10.46"N 127°29'45.83"E
10	36°43'23.26"N	127°29'58.18"E	

LEGEND	
	HOT SPOT WITH IDENT
	HELIPAD

Change : Information of ACFT stands(NR. 1~8, 10, 11, 91~98 → NR. 1~13, 71~78).

MARKING AIDS RWY 06L/24R AND 06R/24L AND EXIT TWY

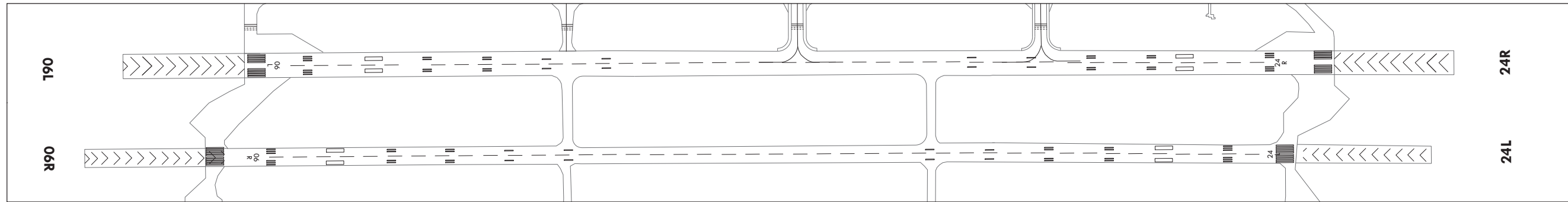

LIGHTING AIDS RWY 06L/24R AND 06R/24L AND EXIT TWY

